

# REM STATIONS

Lemay + Perkins & Will + Bisson Fortin

## LANDSCAPE UNITS

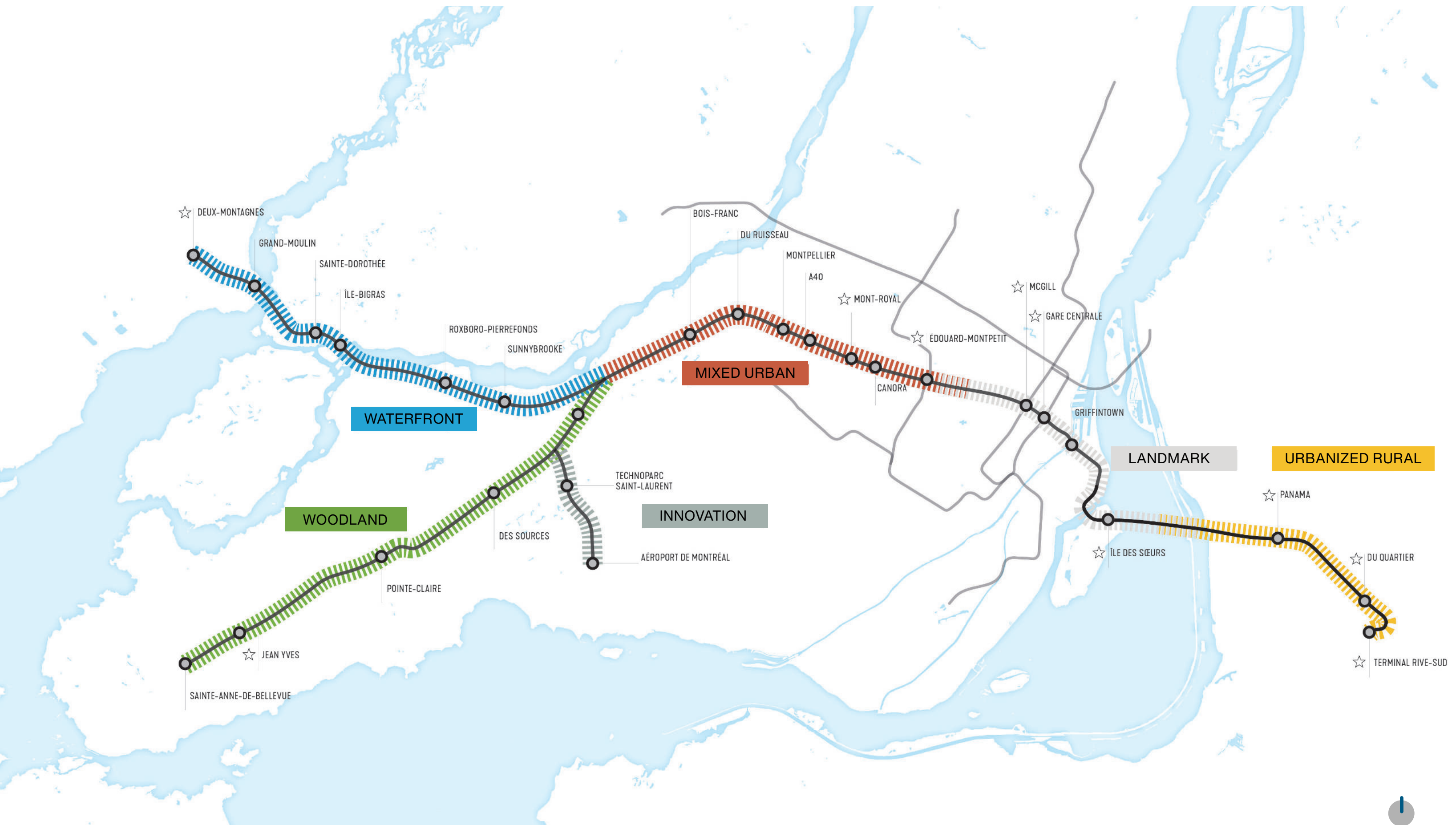

## STATION TYPOLOGIES

### LEGEND

- ELEVATED
- AT GRADE
- UNDERGROUND
- SIGNATURE STATIONS
- BUS TERMINUS
- INTERMODAL STATIONS
- STATION NAME
- ARCHITECTS

- 1 ELEVATED**  
DEUX-MONTAGNES  
ROXBORO-PIERREFONDS  
SUNNYBROOKE  
JEAN-YVES  
POINTE-CLAIRE  
DES SOURCES  
GRIFFINTOWN
- 2 BURIED**  
STE-DOROTHÉE  
MONTPELLIER
- 3 AT-GRADE**  
GRAND-MOULIN  
BOIS-FRANC  
DU RUISSEAU  
RIVE SUD  
A40  
DU QUARTIER  
STE-ANNE-DE-BELLEVUE  
ÎLE-DES-SŒURS  
PANAMA  
ÎLE-BIGRAS
- 4 TRENCHED**  
MONT ROYAL  
CANORA
- 5 UNDERGROUND**  
EDOUARD-MONTPETIT  
MCGILL  
GARE-CENTRALE  
TECHNOPARC  
AÉROPORT DE MONTRÉAL

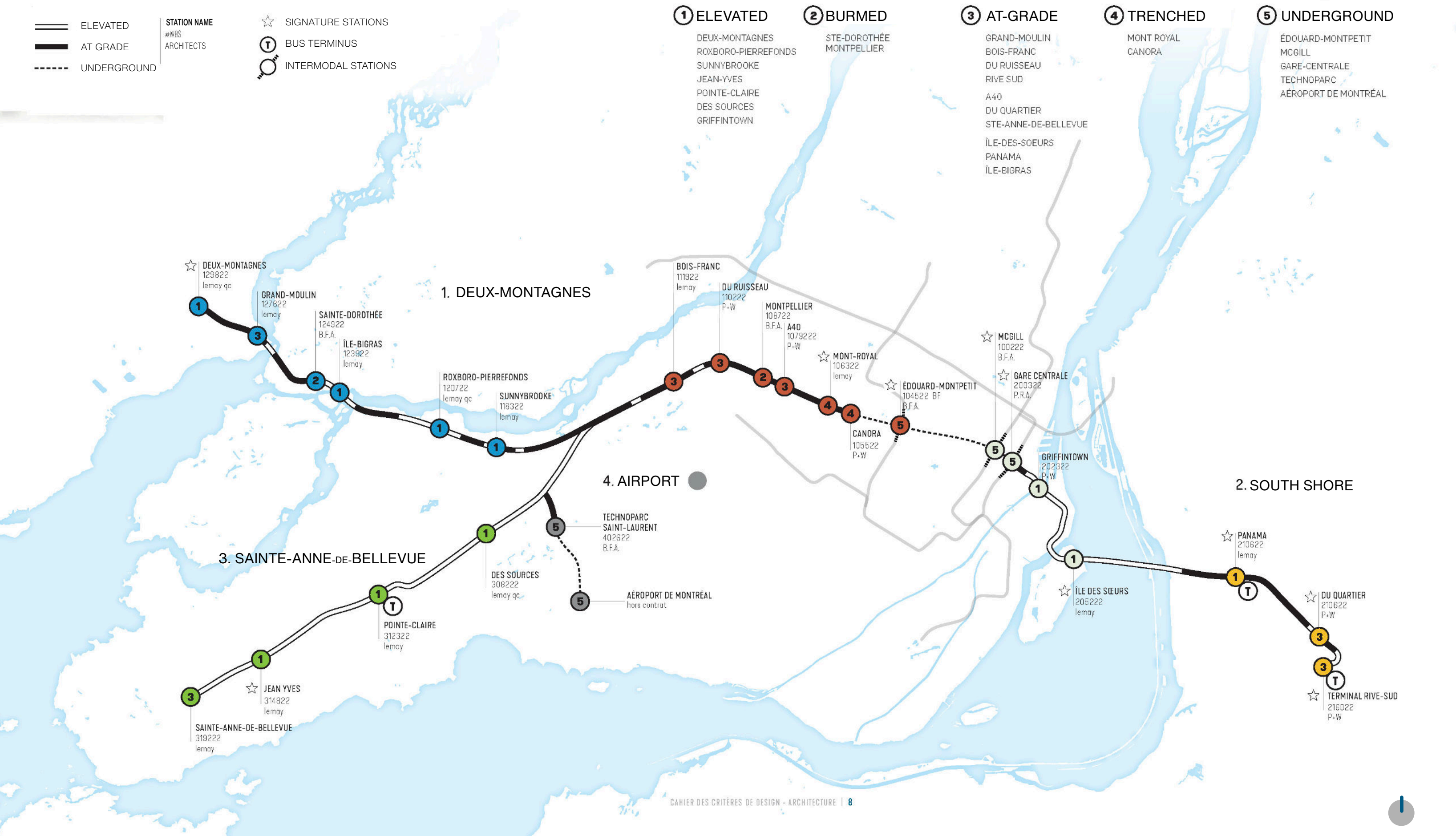

# REM STATIONS

Lemay + Perkins & Will + Bisson Fortin

## STATION TYPOLOGIES

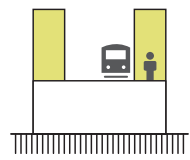

ELEVATED

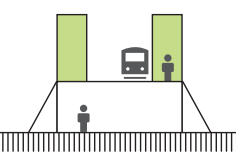
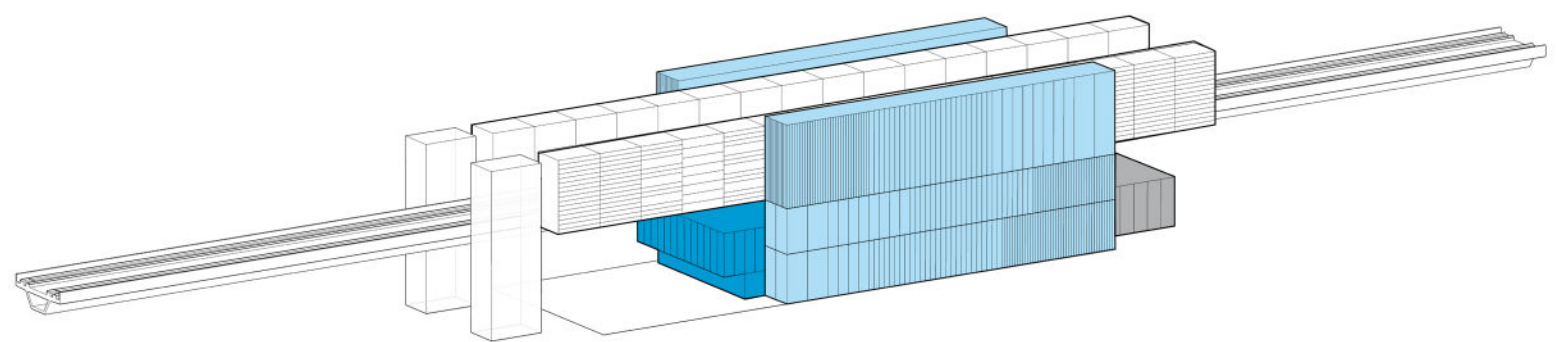

BURIED

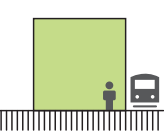
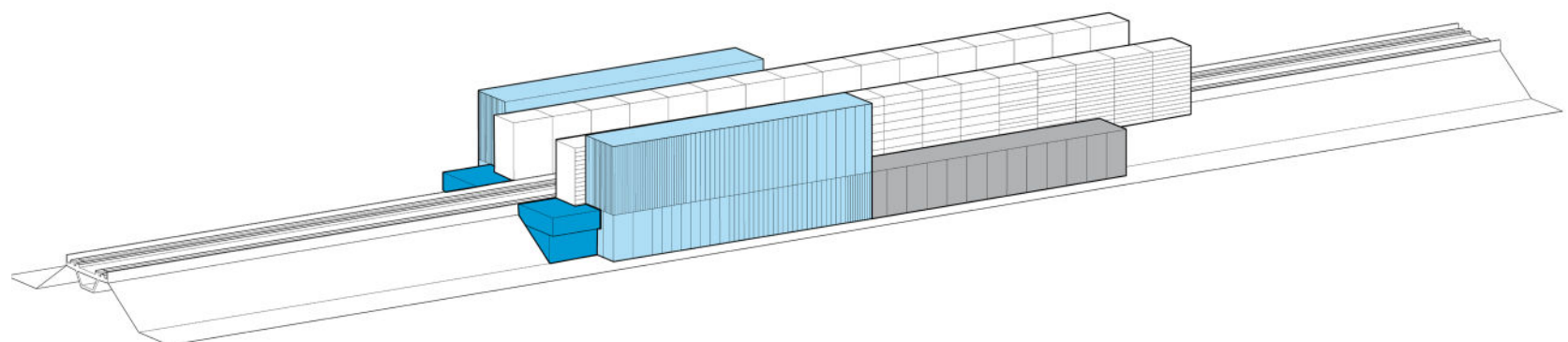

AT-GRADE

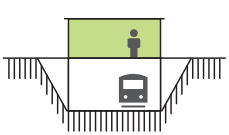
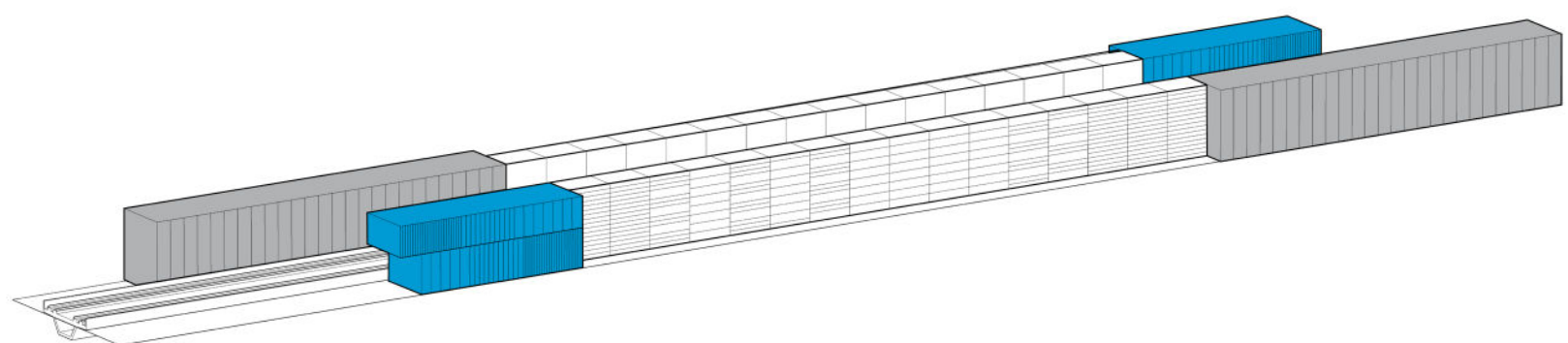

TRENCHED

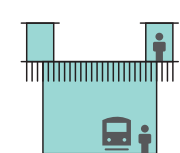
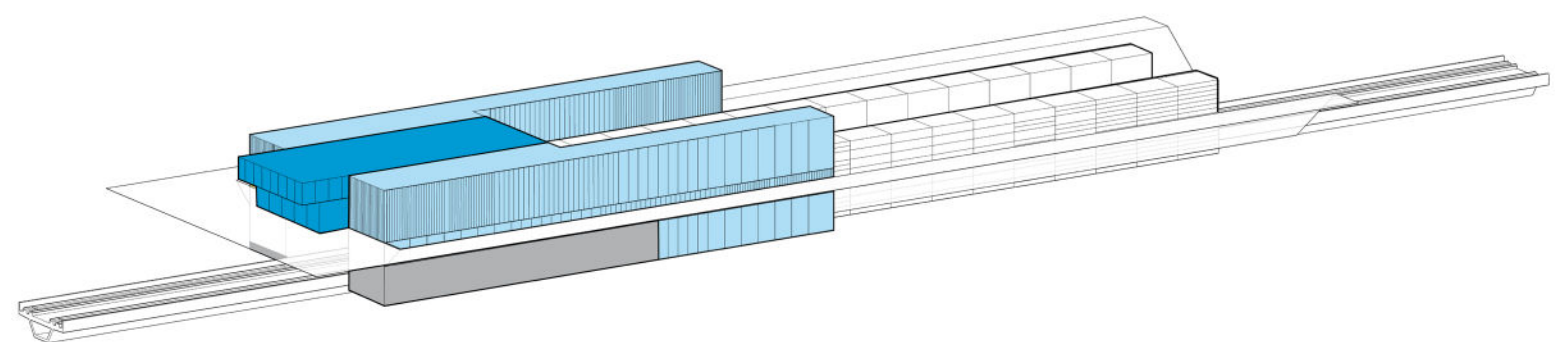

UNDERGROUND

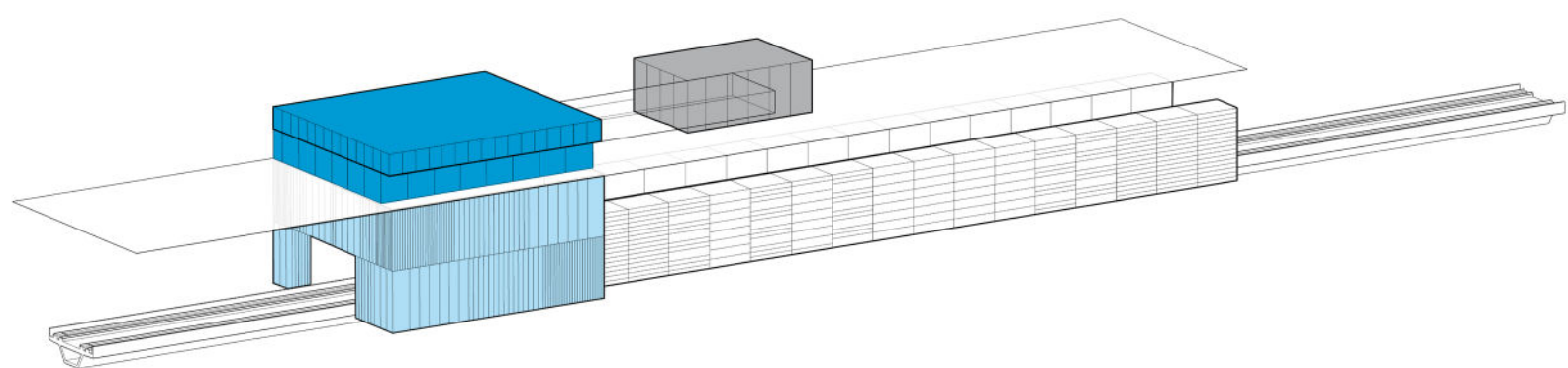

## CONNECTING A NETWORK OF OVER 60 KILOMETRES

Behind the REM's visual unity lie six landscape units and five station typologies. This dual system, codified in the Design Charter, is what makes each station both recognizable across the network and specific to its setting.